

# Pressure Reducing Regulators

## RG50 Model

The RG50 is a pressure reducing regulator used in natural gas distribution systems. The RG50 provides high accuracy, no atmospheric bleed and a heavy main spring for tight shutoff.

High-capacity pressure control, excellent low-flow control and ease of maintenance make the RG50 the perfect solution for pressure reducing applications. Two pilot options with different spring ranges are available. RG50H has a spring range of 10-65 psi and RG50HP has a spring range of 35-100 psi.

### Specifications

**Sizes:** 2"

**Connection:** Female NPT, flanged

**Body Type:** Globe

**Port Sizes:** 7/8", 1 1/8",

Reduced Sizes 7/8" x 5/8", 7/8" x 1/2", 7/8" x 3/8"

**Spring Range:** RG50H 10-65 psi, RG50PH 35-100 psi

**Maximum Inlet Pressure:**

**7/8" Orifice:** 400 psi

**1-1/8" Orifice:** 300 psi

**Temperature Range:**

**Viton:** 0° F to 300° F (-18° C to 149° C)

**Buna, Nylon, Neoprene:** -20° F to 180° F (-29° C to 82° C)

**Set Pressure Range:** 35 to 100 psi

**Maximum Actuator Pressures:**

**Operating:** 100 psi

**Emergency:** 110 psi

**Maximum Pilot Spring Case Pressure for Pressure Loading:**

100 psi

**Maximum Rated Travel:** 1/4 in/ 6.4 mm

**Weight:** 115lbs

**Proportional Band:** 1 to 2 psi In. W.C.

**Materials:**

**Body:** Ductile iron

**Actuator Casing:** Ductile iron

**Pilot Body and Spring Case:** Ductile iron

**Orifice, Disk Holder and Shuttle:** Brass

**Disk:** Buna, Viton®, nylon

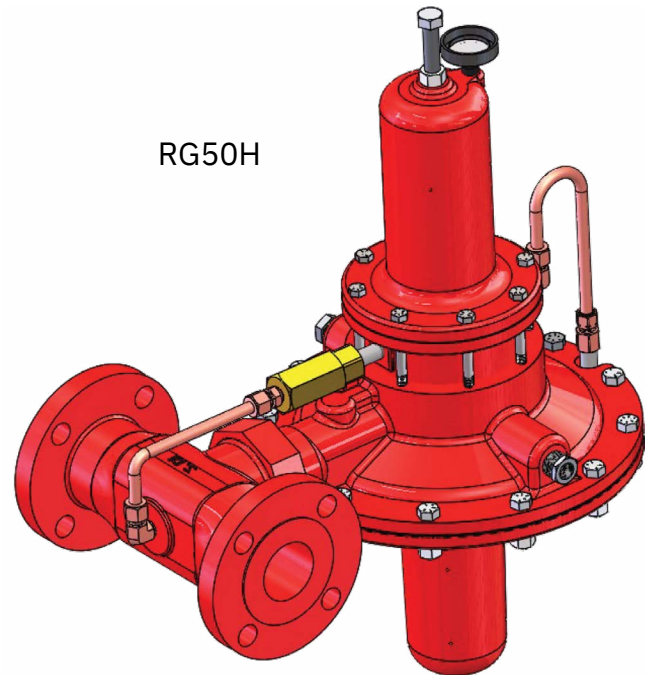

RG50H



RG50HP

#### Body Pressure Ratings

	NPT600 psi
150 Class Flange	250 psi
300 Class Flange	640 psi

All trademarks and service marks used in this document are the property of their respective owners. This Beaumont Manufacturing and Distribution Co. product is exclusively distributed for new equipment packages by FW Murphy in the Natural Gas Compression market.

# Capacities of 0.6 S.G. Natural Gas in Thousand SCFH

Inlet Pressure		Outlet Pressure, psig/bar with Orifice Size 7/8 (22 mm)																							
		10 / 0.7		15 / 1.0		20 / 1.4		25 / 1.7		30 / 2.1		35 / 2.4		40 / 2.8		45 / 3.1		50 / 3.5		60 / 4.1		75 / 5.2		100 / 6.9	
psi	bar	SCF H	Nm <sup>3</sup> /h	SCF H	Nm <sup>3</sup> /h	SCF H	Nm <sup>3</sup> /h	SCF H	Nm <sup>3</sup> /h	SCF H	Nm <sup>3</sup> /h	SCF H	Nm <sup>3</sup> /h	SCF H	Nm <sup>3</sup> /h	SCF H	Nm <sup>3</sup> /h	SCF H	Nm <sup>3</sup> /h	SCF H	Nm <sup>3</sup> /h	SCF H	Nm <sup>3</sup> /h	SCF H	Nm <sup>3</sup> /h
8	1	7.8	0.2																						
15	1.4	14.4	0.4	10.8	0.3																				
20	1.7	19.2	0.5	16.2	0.4	12	0.3																		
25	2.1	23	0.6	20	0.5	17	0.5	12.5	0.3																
30	2.1	26	0.7	24	0.6	21	0.6	18	0.5	13	0.3														
35	2.8	28	0.8	28	0.8	26	0.7	23	0.6	19	0.5	14.4	0.4												
40	3.4	34	0.9	34	0.9	34	0.9	31	0.8	28	0.8	25	0.7	21	0.6	15.5	0.4								
50	4.1	42	1.1	42	1.1	42	1.1	42	1.1	37	1.0	35	0.9	30	0.8	27	0.7	23	1.6						
60	5.2	47	1.3	47	1.3	47	1.3	47	1.3	47	1.3	47	1.3	45	1.2	41	1.1	37	1.0	30	0.8				
75	6.9	59	1.3	59	1.6	59	1.6	59	1.6	59	1.6	59	1.6	59	1.6	59	1.6	59	1.6	53	1.4	44	1.2		
100	8.6	73	2.0	73	2.0	73	2.0	73	2.0	73	2.0	73	2.0	73	2.0	73	2.0	73	2.0	73	2.0	66	1.8	48	1.3
125	10.3	86	2.3	86	2.3	86	2.3	86	2.3	86	2.3	86	2.3	86	2.3	86	2.3	86	2.3	86	2.3	86	2.3	72	1.9
150	12.1	96	2.6	96	2.6	96	2.6	96	2.6	96	2.6	93	2.6	93	2.6	93	2.6	93	2.6	93	2.6	93	2.6	93	2.5
175	13.8	108	2.9	108	2.9	108	2.9	108	2.9	108	2.9	108	2.9	108	2.9	108	2.9	108	2.9	108	2.9	108	2.9	108	2.9
200	15.5	123	3.3	123	3.3	123	3.3	123	3.3	123	3.3	123	3.3	123	3.3	123	3.3	123	3.3	123	3.3	123	3.3	123	3.3
225	17.2	132	3.5	132	3.5	132	3.5	132	3.5	132	3.5	132	3.5	132	3.5	132	3.5	132	3.5	132	3.5	132	3.5	132	3.5
250	20.7	162	4.3	162	4.3	162	4.3	162	4.3	162	4.3	162	4.3	162	4.3	162	4.3	162	4.3	162	4.3	162	4.3	162	4.3
300	24.1	188	5.0	188	5.0	188	5.0	188	5.0	188	5.0	188	5.0	188	5.0	188	5.0	188	5.0	188	5.0	188	5.0	188	5.0
350	27.6	215	5.8	215	5.8	215	5.8	215	5.8	215	5.8	215	5.8	215	5.8	215	5.8	215	5.8	215	5.8	215	5.8	215	5.8
400																									
Inlet Pressure		Outlet Pressure, psig/bar with Orifice Size 1-1/8 (29 mm)																							
		10 / 0.7		15 / 1.0		20 / 1.4		25 / 1.7		30 / 2.1		35 / 2.4		40 / 2.8		45 / 3.1		50 / 3.5		60 / 4.1		75 / 5.2		100 / 6.9	
psi	bar	SCF H	Nm <sup>3</sup> /h	SCF H	Nm <sup>3</sup> /h	SCF H	Nm <sup>3</sup> /h	SCF H	Nm <sup>3</sup> /h	SCF H	Nm <sup>3</sup> /h	SCF H	Nm <sup>3</sup> /h	SCF H	Nm <sup>3</sup> /h	SCF H	Nm <sup>3</sup> /h	SCF H	Nm <sup>3</sup> /h	SCF H	Nm <sup>3</sup> /h	SCF H	Nm <sup>3</sup> /h	SCF H	Nm <sup>3</sup> /h
15	1	13	0.4																						
20	1.4	24	0.6	18	0.5																				
25	1.7	32	0.9	27	0.7	20	0.5																		
30	2.1	39	1.0	34	0.9	28	0.8	21	0.6																
35	2.1	44	1.2	40	1.1	35	0.9	30	0.8	22	0.6														
40	2.8	47	1.3	47	1.3	43	1.2	38	1.0	32	0.9	24	0.6												
50	3.4	57	1.5	57	1.5	57	1.5	52	1.4	47	1.3	42	1.1	35	0.9	26	0.7								
60	4.2	65	1.7	65	1.7	65	1.7	65	1.7	62	1.7	58	1.6	50	1.3	45	1.2	38	1.0						
75	5.2	78	2.1	78	2.1	78	2.1	78	2.1	78	2.1	74	2.0	68	1.8	60	0.9	50	1.3						
100	6.9	99	2.7	99	2.7	99	2.7	99	2.7	99	2.7	99	2.7	99	2.7	99	2.7	99	2.7	88	2.4				
125	8.6	122	3.3	122	3.3	122	3.3	122	3.3	122	3.3	122	3.3	122	3.3	122	3.3	122	3.3	122	3.3	122	3.3	80	2.1
150	10.3	143	3.8	143	3.8	143	3.8	143	3.8	143	3.8	143	3.8	143	3.8	143	3.8	143	3.8	143	3.8	143	3.8	120	3.2
175	12.1	160	4.3	160	4.3	160	4.3	160	4.3	160	4.3	160	4.3	160	4.3	160	4.3	160	4.3	160	4.3	160	4.3	155	4.2
200	13.8	180	4.8	180	4.8	180	4.8	180	4.8	180	4.8	180	4.8	180	4.8	180	4.8	180	4.8	180	4.8	180	4.8	180	4.8
225	15.5	205	5.5	205	5.5	205	5.5	205	5.5	205	5.5	205	5.5	205	5.5	205	5.5	205	5.5	205	5.5	205	5.5	205	5.5
250	17.2	220	5.9	220	5.9	220	5.9	220	5.9	220	5.9	220	5.9	220	5.9	220	5.9	220	5.9	220	5.9	220	5.9	220	5.9
300	20.7	265	7.1	265	7.1	265	7.1	265	7.1	265	7.1	265	7.1	265	7.1	265	7.1	265	7.1	265	7.1	265	7.1	265	7.1

- Grayed out areas indicate that the inlet pressure is too high for a given orifice size.

- To convert capacities to another gas, multiply by .775 and divide by the square root of the specific gravity of the desired gas. -

To convert SCFH to m3 /hr, multiply by 0.0268

# Maximum Allowable Pressure Drop and Minimum Differential Pressures

Maximum Allowable Pressure Drop		Minimum Differential Pressure for Full Stroke		Disk Material	Maximum Orifice Size
psig	bar	psig	bar		In.
150	10.3	3	0.21	Buna and Viton	1 1/8
250	17.2	3	0.21	Buna and Viton	7/8
300	20.7	10	0.69	Nylon	1 1/8
400	27.6	10	0.69	Nylon	7/8

## Dimensions

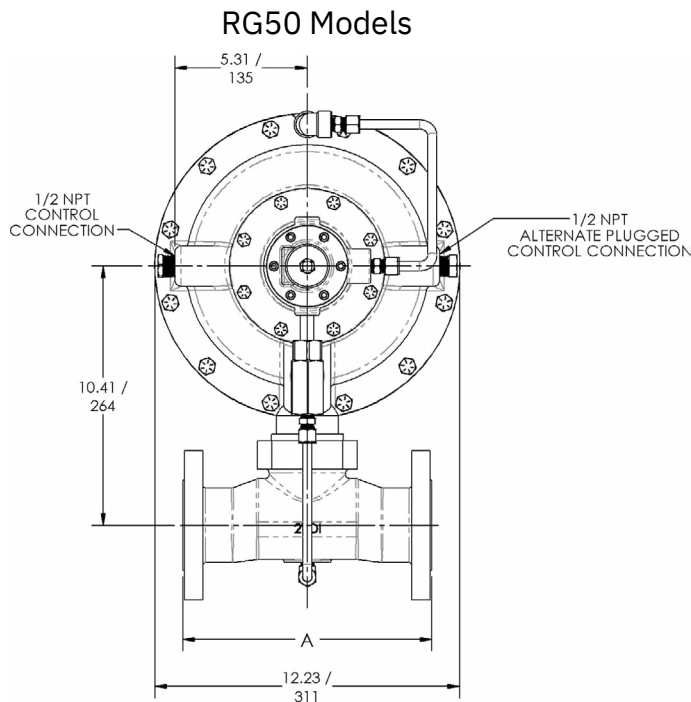
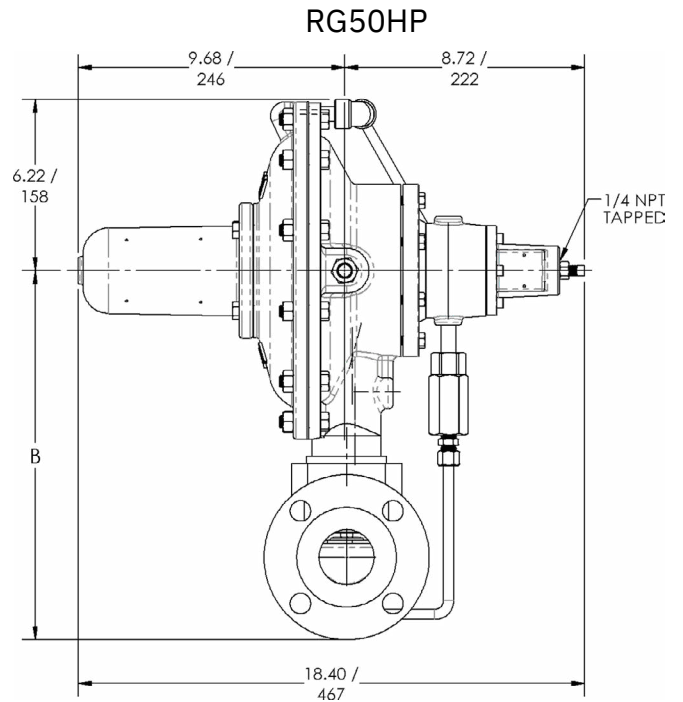
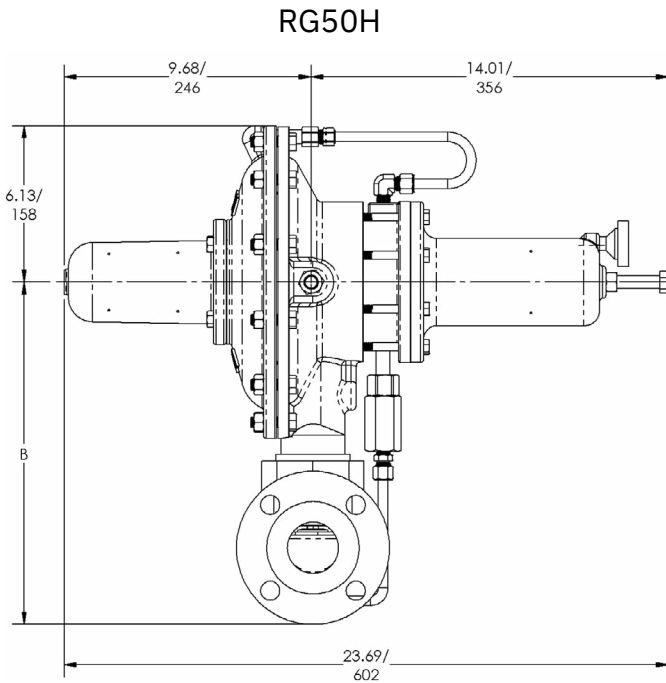

Dimensions		
Body	A	B
NPT	6.25"	12.28"
Class 150	10.00"	13.41"
Class 300	10.50"	13.66"

# How to Order

Options are listed below. All configurations may not be available. Call your sales representative or FW Murphy for more information. Repair kits are available.

Example Model No. **RG50HP-2N50-BN7**

RG50 Series, HP 35-100 psi Pilot, 2" Body, Threaded Ends, Brass Trim with Nylon Seat, 7/8" Port

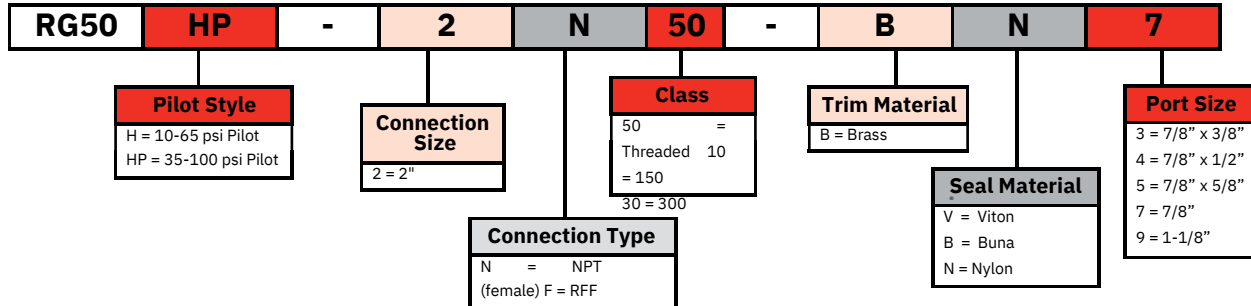

FW Murphy is the exclusive BMD distributor for new equipment packages.



## CONTACT

✉ sales@rajkotmarinellc.ae  
☎ +971 6 7487580  
🌐 www.rajkotmarine.com

## RAJKOT MARINE LLC

Jerf Industrial Area 1,  
P.O Box 5861  
Ajman, UAE

